



# MULTI-FAMILY DIVISION

**DUPLEX PLAN**  
**BI-LEVEL**



ARTIST RENDERING OF THE BAYPORT I DUPLEX

**THE BAYPORT** | The Bayport I as pictured features a front tower projection with a dormer as a standard feature. Optional features include the high pitched roof, wide cornerposts, window grills, mantels, shutters and front entry door with sidelights. The stone accent and entire porch are site provided and installed.

**THE BAYPORT I DUPLEX**  
26'-0" X 56'-0"  
684 SQ. FT. per dwelling | 1 BR | 1 BATH

**THE BAYPORT II DUPLEX**  
27'-6" X 60'-0"  
781 SQ. FT. per dwelling | 1 BR | 1 BATH

DESIGNED FOR FULL BASEMENT FOUNDATION

**SIMPLEX INDUSTRIES INC.**  
KEYSER VALLEY INDUSTRIAL PARK  
1 SIMPLEX DRIVE  
SCRANTON, PA 18504  
(570) 346.5113  
www.simplexhomes.com

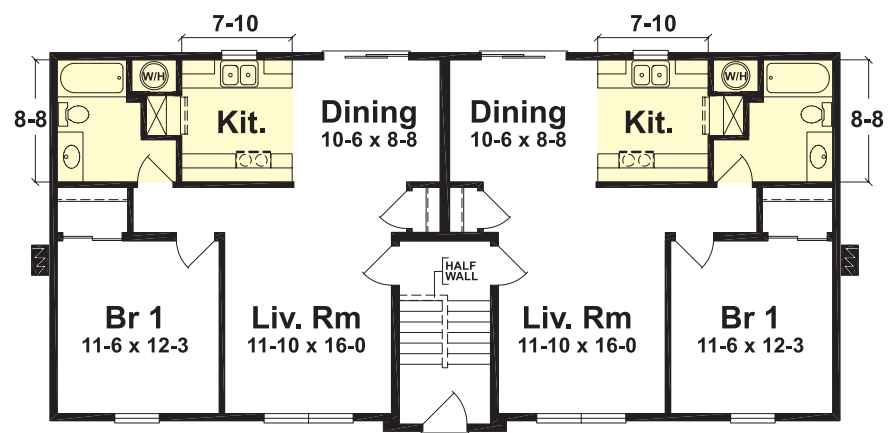

**BAYPORT I**

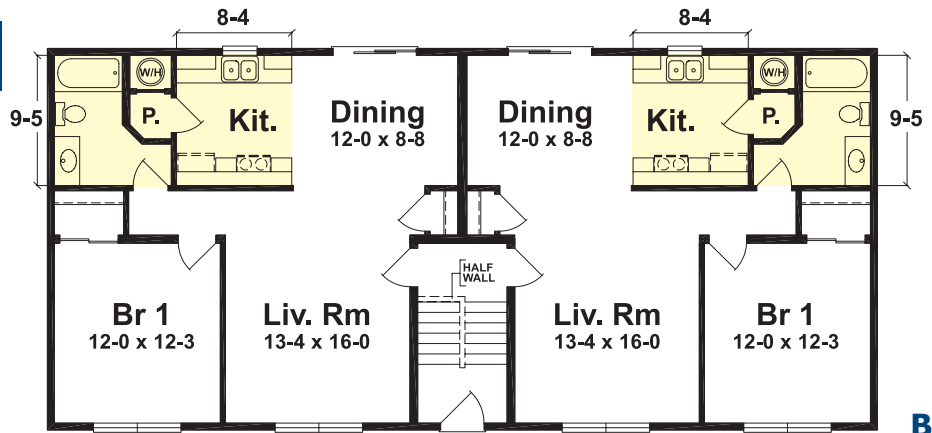

**BAYPORT II**

= linoleum areas

PLEASE SEE THE REVERSE SIDE OF THIS SHEET FOR ADDITIONAL INFORMATION AND HOME PLANS.



# MULTI-FAMILY DIVISION

# DUPLEX PLAN BI-LEVEL



ARTIST RENDERING OF THE BAYPORT DUPLEX

**THE BAYPORT**

The Bayport as shown features the following optional products: high pitched roof, dormer with shakes, window mantels, grills, shutters and front door with sidelights and circle top. The porch is site supplied and installed.

**THE BAYPORT III  
DUPLEX**  
27'-6" X 60'-0"

781 SQ. FT. per dwelling    2 BR  
1 BATH

**THE BAYPORT IV  
DUPLEX**  
27'-6" X 64'-0"

836 SQ. FT. per dwelling    2 BR  
1 BATH

DESIGNED FOR FULL  
BASEMENT FOUNDATION

**SIMPLEX INDUSTRIES INC.**  
KEYSER VALLEY INDUSTRIAL PARK  
1 SIMPLEX DRIVE  
SCRANTON, PA 18504  
(570) 346.5113  
www.simplexhomes.com

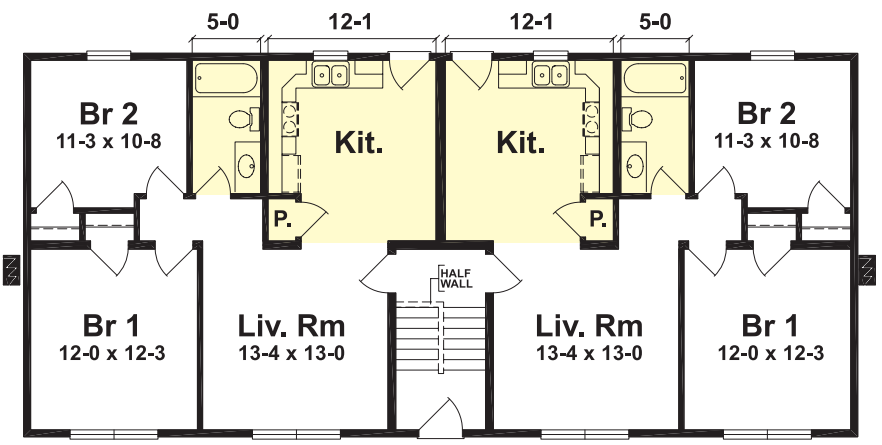

**BAYPORT III**

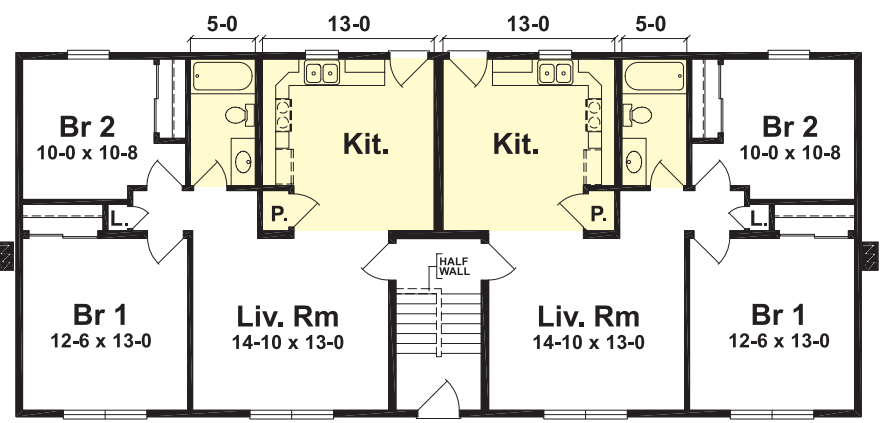

**BAYPORT IV**

= linoleum areas

**"Building Homes With You In Mind"**

Artist renderings depict typical finished homes and generally include some optional exterior features. Standard specifications and pricing available on request. Specifications may be subject to revision as required by use and location.